

Whitfield Gardens: Reviving a forgotten West End space

The West End Project is Camden Council's £35 million scheme to deliver exciting improvements to the heart of Camden's busy West End. Major changes underway include Tottenham Court Road and Gower Street/Bloomsbury Street becoming two-way to traffic. This will reduce congestion and air pollution, speed up bus routes and make cycling safer.

One of the most significant transformations is the creation of new and regenerated public and green spaces, including Whitfield Gardens, an existing space lying at the heart of the area.

As it stands, although much-loved by the local community the Gardens are dark and hidden and a magnet for anti-social behaviour. LDA Design, in partnership with Camden Council, hopes to revive this cherished green space, opening up views, removing hidden nooks and providing a safe and attractive place for residents and visitors.

Communal dining, rainwater gardens and an events space will define the space. The Fitzrovia Mural will also be restored.



Client
London Borough of Camden

Location
Camden, London

Partners
DSDHA, Norman Rourke Pryme

Services
Landscape Architecture

Area
0.1 ha

¹⁻³ Whitfield Gardens, a place where lives can easily overlap. Visualisation includes the restored Fitzrovia Mural

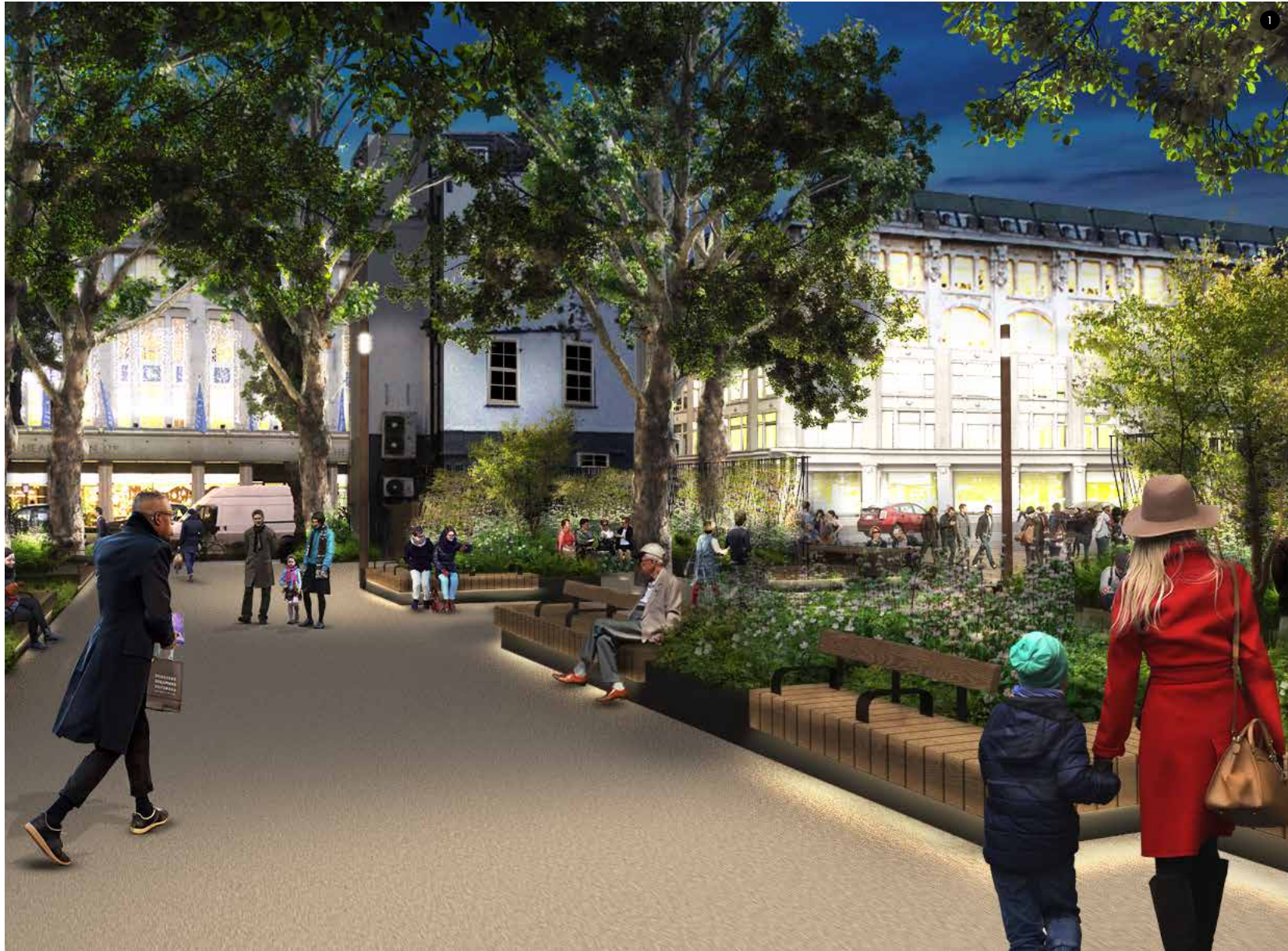

¹ Whitfield Gardens
at night, central London